

Prior Scientific Help Guides and Installation Instructions

UPDATED 3 September 2015

Lumen 200 Bulb Installation (Old variants)

BULB INSTALLATION ON THE LUMEN 200 (OLDER VARIANTS)

BEFORE USING THIS GUIDE PLEASE SEE 'BULB INSTALLATION FOR THE LUMEN 200 SERIES'. ONLY USE THIS GUIDE IF YOUR LUMEN 200 IS AN OLDER MODEL AND THE ABOVE GUIDE IS THEREFORE NOT APPLICABLE.

Required equipment

- Lumen 200
- Alan key
- Bulb – supplied by Prior Scientific.

Instructions

1. Disconnect the Lumen from the mains power supply.
2. If the Lumen has been previously switched on wait for thirty minutes to allow the bulb to cool.
3. Find a flat surface and place the Lumen upside down on the surface. If you are right handed it is best to do this with the front to you, if you are left handed it is best to place the front away from you.
4. Unscrew the four hex screws (circled) and remove the panel as indicated in the diagram below.

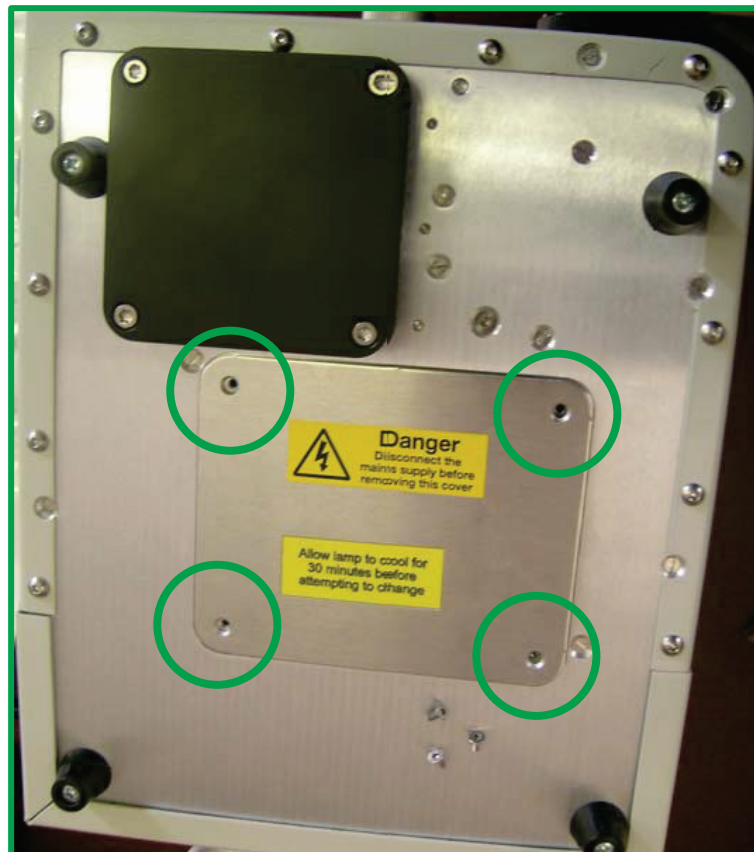

5. Remove bulb from the carton (see below).
 - a) Open the top of the carton
 - b) Remove V shaped cardboard holder
 - c) Push cardboard flaps back
 - d) Lift bulb out of carton

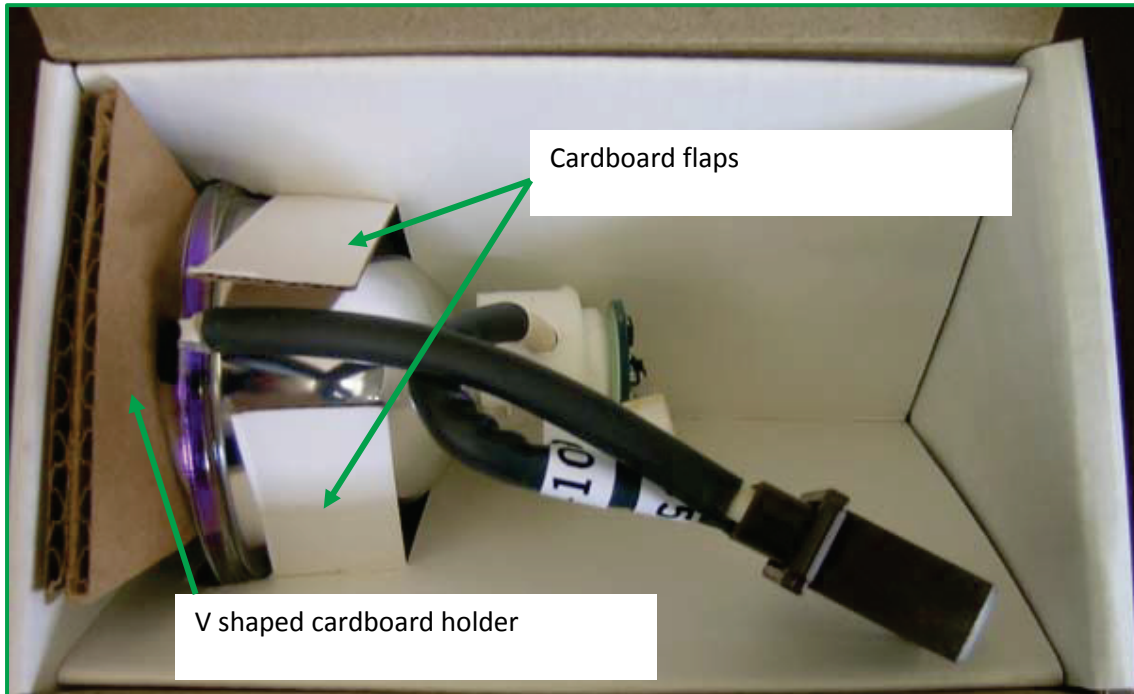

6. Plug the brown connector on the bulb into the black socket in the bulb housing and ensure it is pushed firmly into position. This will orientate the bulb with the cables facing into the bulb housing the (Hg) label facing upwards.
7. Locate the bottom of the bulb (as indicated in the figure below) into the groove in the bottom (lamp house clamp) of the lamp housing.

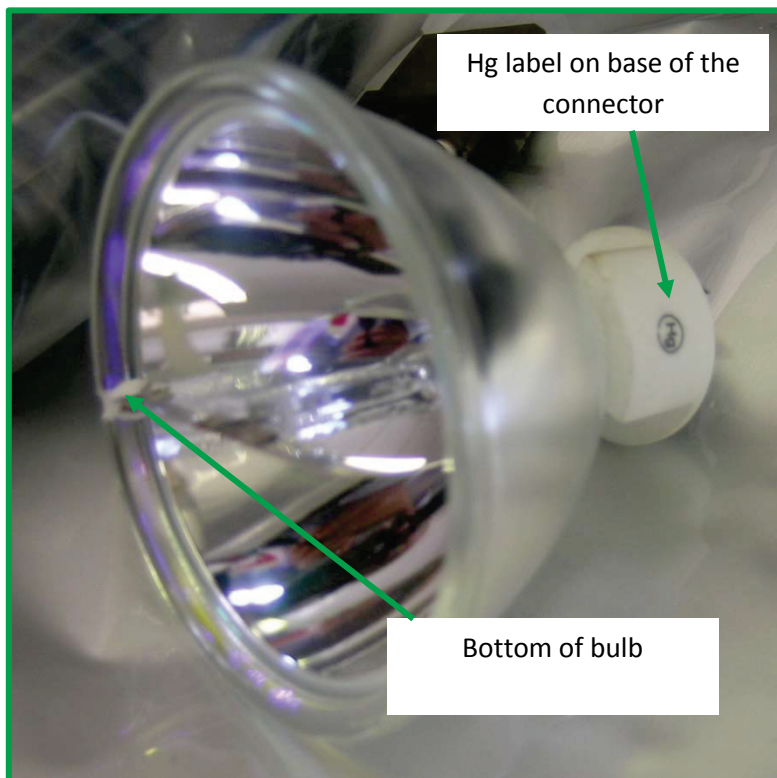
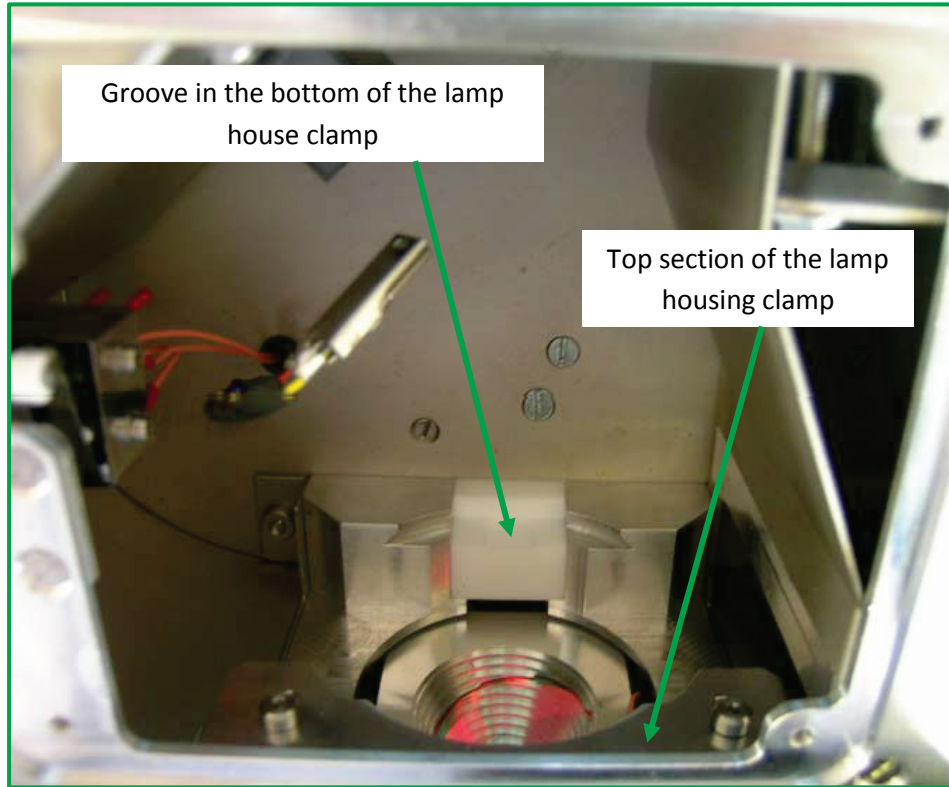

8. Lift the top section of the lamp housing clamp with two fingers.

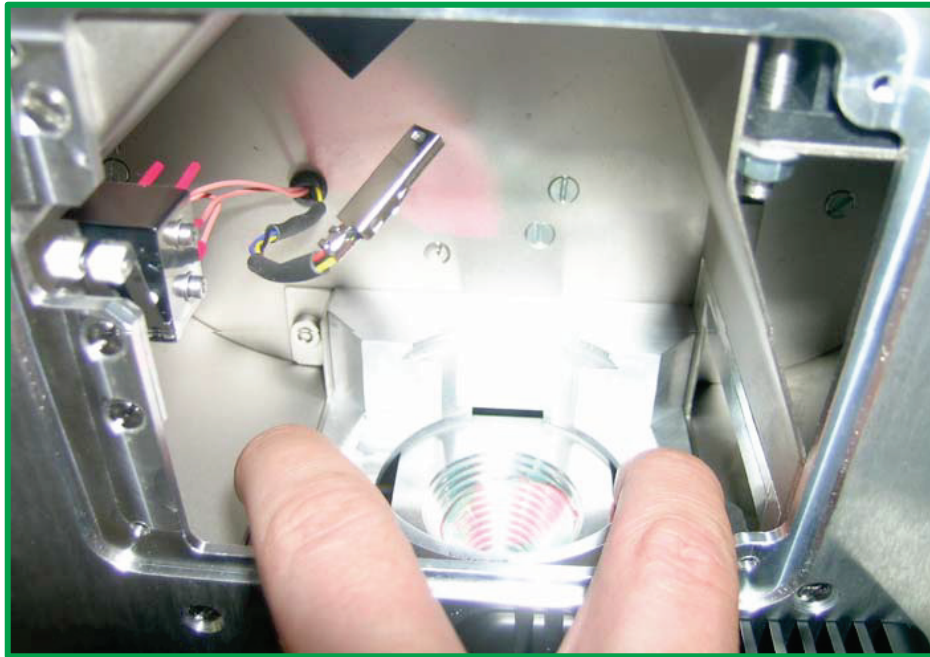

9. Push the bulb gently into place and release the top section of the map housing clamp. Ensure that the metal strip in the bulb is vertical (i.e. the Hg label is facing vertically upwards) and that the bottom of the bulb is in the bottom of the bulb housing clamp.
10. Plug the secondary connector into the base of the bulb and hold the bulb while pushing the connector firmly into place. Take care not to dislodge the bulb.

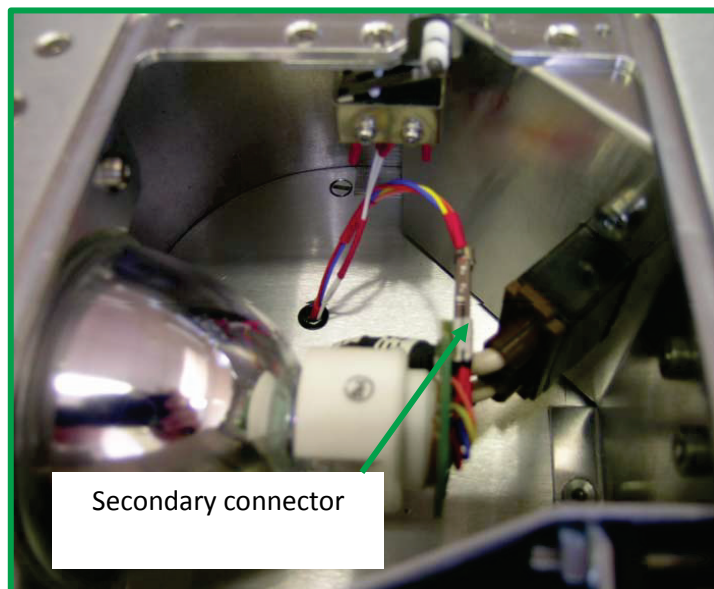

11. Replace the bulb housing cover and replace the four hex nuts.